

# STAG HOUSE DEVELOPMENT



## PROJECT NEWSLETTER

JULY 2018

ISSUE NUMBER 2

Welcome to the second edition of our project newsletter for the Stag House Development. When the main works start on site we will be sending through these regular newsletters to keep you up to date on current construction progress, planned future works and how these may affect you.

### SUMMARY OF PROGRESS TO DATE

Works will be starting on site on the 6th Aug 2018. We will be undertaking a number of tasks over the next 5/6 weeks:

- Firstly we will be securing the building and the multi-use games area (MUGA) by changing locks.
- We will be taking delivery of the site cabins and skip
- Reposition of three existing commercial bins near to the site
- Secure car park to both side of MUGA to fell 4no trees. The car park will be out of use for three days and all residents affected will be notified of the days in due course.
- Tree pruning and felling. All trees will be checked for any indication of bird nesting. If any nests are discovered by the team, the tree will not be pruned until a date in the future.
- We will be clearing and removing all shrubs/ debris from site.
- The erection of the hoarding will commence on the right hand side of the MUGA and continue around the site boundary (as highlighted in the diagram overleaf).
- We will start soft stripping to building, this involves the removal of all non-structural elements, for example kitchen, doors etc..

### FUTURE WORKS

- Demolition of the building will commence straight after the soft stripping out, the duration of this will be approximately four weeks.
- Once demolition is complete the piling works will commence.

### DATE FOR THE DIARY

We recognise that when we met with many of you at the 'meet the contractor' event in June 2017. The hoarding and the boundary lines were slightly different. We would like to invite you to meet with the team to ask any questions or discuss any concerns. The team will be available on **Thursday 26th July, 5.30pm till 7pm at Newlands Hall, 226 Stroud Crescent, Putney Vale, London SW15 3EP**



Wates is a long-time associate member of the Considerate Constructors Scheme (CCS) and as such, welcomes your comments on the project.

Should you wish to discuss the project with a member of the team, the Project Manager, Reza Shahin, can be contacted at the main site office on **07548 707973** or by email to **reza.shahin@wates.co.uk**



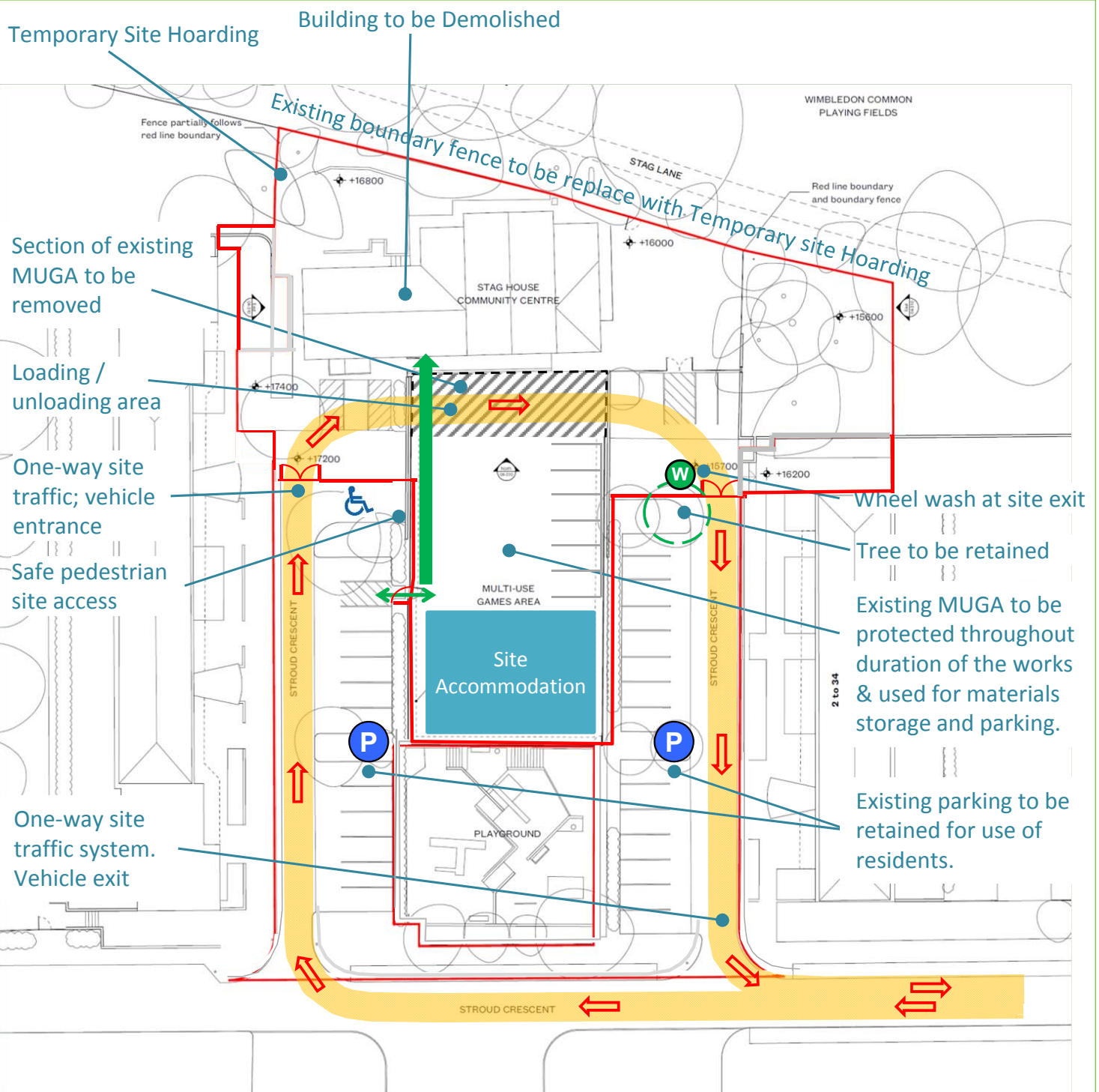

LOGISTICS PLAN

**OUR PERMITTED SITE WORKING HOURS ARE :**  
**Monday to Friday 8am to 6pm and Saturday 8am to 1pm**

Our working hours have been stipulated by the London Borough of Wandsworth planning department to make sure that our work does not take place during unsociable hours. However, on the rare occasion that we need to work outside of these hours, we will write to you and let you know in advance. As activities and deliveries increase on site we apologise in advance for any inconvenience that the works may cause and thank you for your patience and co-operation.

Wates is a long-time associate member of the Considerate Constructors Scheme (CCS) and as such, welcomes your comments on the project.

Should you wish to discuss the project with a member of the team, the Project Manager, Reza Shahin, can be contacted at the main site office on **07548 707973** or by email to **reza.shahin@wates.co.uk**

