

Wandsworth Borough Council

TOWN AND COUNTRY PLANNING ACT 1990

SECTION 247

MENDIP ROAD

THE LONDON BOROUGH OF WANDSWORTH hereby gives notice that it has made an Order under Sections 247 of the Town and Country Planning Act 1990 to authorise the stopping up of the highway described in the First Schedule.

THE ORDER IS MADE to enable the development described in the Second Schedule to this notice to be carried out subject to the granting of planning consent under Part III of the Town and Country Planning Act 1990 by the London Borough of Wandsworth on 30 November 2020 under local planning authority reference 2019/5484.

COPIES OF THE ORDER AND RELEVANT PLAN MAY BE INSPECTED FREE OF CHARGE between 09:00 and 17:00 during a period of 28 days commencing on 4 February 2021 at the Planning and Development offices at Wandsworth Town Hall, Wandsworth High Street, SW18 2PU, and on the Council's website at: <https://www.wandsworth.gov.uk/roads-and-transport/road-safety/traffic-management-orders-tmos/> Reference SO/002/20.

ANY PERSON aggrieved by the Order and desiring to question the validity thereof, or of any provision contained therein on the ground that it is not within the powers of the above Act or that any regulation made thereunder has not been complied with in relation to the Order may, within 6 weeks of Thursday 4 February 2021, apply to the High Court for the suspension or quashing of the Order or any provision contained therein.

THE FIRST SCHEDULE

Areas of Highway to be Stopped Up

Part of the adopted highway on the eastern side of Mendip Road, shown as hatched in black on the plan, consisting of an area of 0.165m² running from the existing north-western boundary wall of 41-47 Chatfield Road, SW11 3SE for 0.6m in a northerly direction, and from the north-western boundary wall of 41-47 Chatfield Road, SW11 3SE, for 0.55m in a westerly direction along a total width of the north-western boundary wall of 0.81m.

THE SECOND SCHEDULE

The Location

Land west of 41-47 Chatfield Road, Wandsworth, SW11 3SE.

The development

Demolition of the existing buildings and erection of a podium building with two blocks above (up to 7- and 8-storeys) fronting Chatfield Road and Mendip Road comprising 182 shared-living rooms (Sui Generis) and 81 room hotel (Class C1) with associated internal and external amenity space, office space (Class B1a), cafe/restaurant space (Class A3), flexible workspace and community space (Class B1/D1), landscaping, plant and associated works.

Dated 4 February 2021

PAUL MARTIN

Chief Executive

London Borough of Wandsworth, Wandsworth Town Hall, SW18 2PU

**LONDON BOROUGH OF WANDSWORTH
TOWN AND COUNTRY PLANNING ACT 1990
SECTION 247**

**THE LONDON BOROUGH OF WANDSWORTH
(MENDIP ROAD) STOPPING UP ORDER 2021**

Made this **4th** day of **February** 2021

The London Borough of Wandsworth (“the Council”) makes this Order in exercise of its powers under sections 247 of the Town and Country Planning Act 1990 (as amended) (“the Act”) and all other enabling powers.

1. The Council authorises the stopping up of the areas of highway described in the First Schedule to this Order
2. The order is made to enable the development described in the Second Schedule to be carried out in accordance with the planning permission granted under Part III of the Town and Country Planning Act 1990 by the London Borough of Wandsworth on 30 November 2020 under local planning authority reference 2019/5484.
3. This Order shall come into force on the date on which notice that it has been made is first published in accordance with Section 252 (10) of the Act, and may be cited as the London Borough of Wandsworth (Mendip Road) Stopping Up Order 2021

Signed by Authority of
The Council of the London
Borough of Wandsworth

Signed by **Jennifer Jackson** (Assistant Director for Planning and Transport Strategy) for **Paul Chadwick** Director of Environment and Community Services



J. Jackson

.....

THE FIRST SCHEDULE

Areas of Highway to be Stopped Up

Part of the adopted highway on the eastern side of Mendip Road, shown as hatched in black on the plan, consisting of an area of 0.165m² running from the existing north-western boundary wall of 41-47 Chatfield Road, SW11 3SE for 0.6m in a northerly direction, and from the north-western boundary wall of 41-47 Chatfield Road, SW11 3SE, for 0.55m in a westerly direction along a total width of the north-western boundary wall of 0.81m.

THE SECOND SCHEDULE

The Location

Land west of 41-47 Chatfield Road, Wandsworth, SW11 3SE.

The development

Demolition of the existing buildings and erection of a podium building with two blocks above (up to 7- and 8-storeys) fronting Chatfield Road and Mendip Road comprising 182 shared-living rooms (Sui Generis) and 81 room hotel (Class C1) with associated internal and external amenity space, office space (Class B1a), cafe/restaurant space (Class A3), flexible workspace and community space (Class B1/D1), landscaping, plant and associated works.

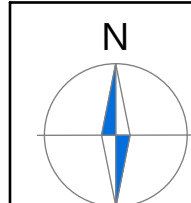

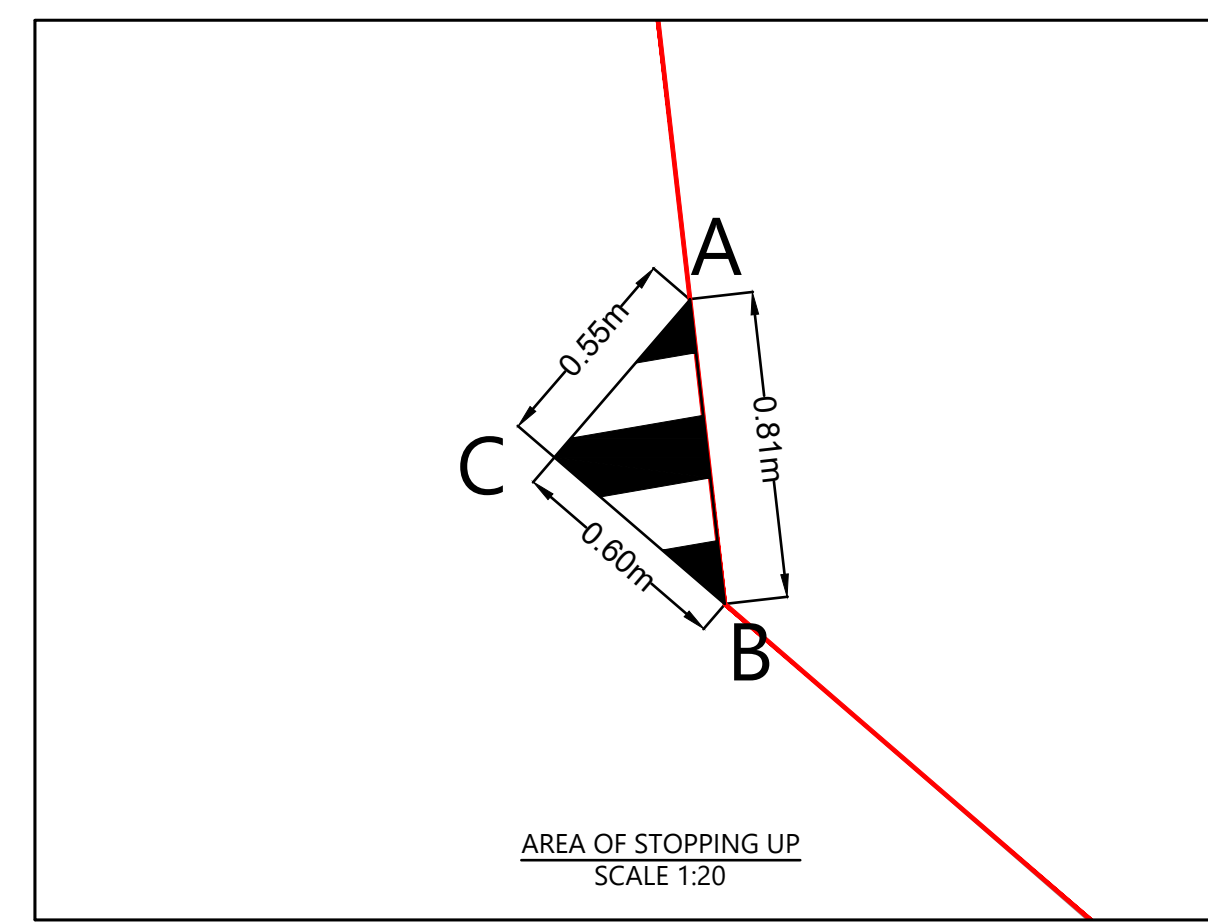
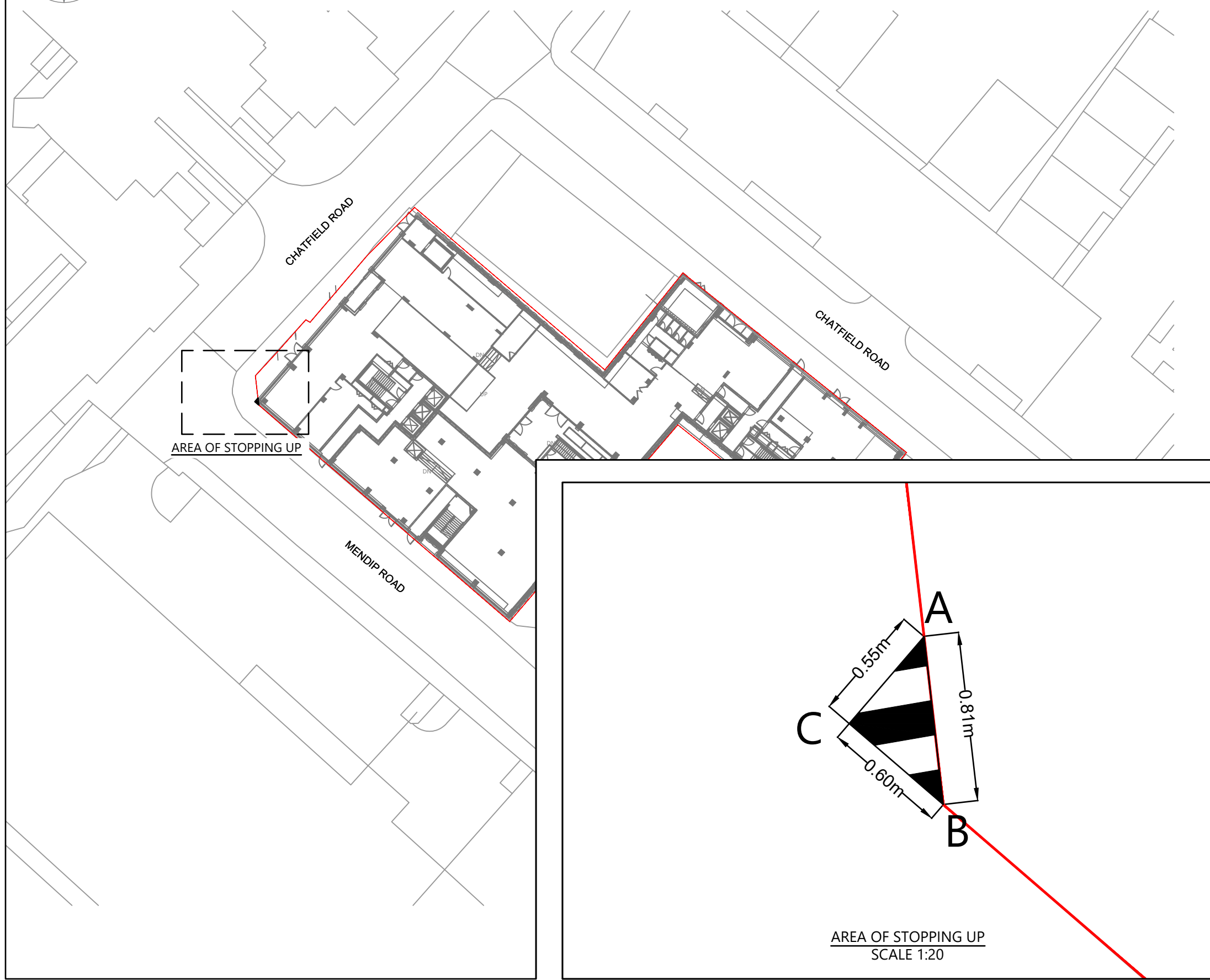

LOCATION PLAN
(with proposed internal layout)
SCALE 1:500



NOTES

1. Do not scale from this drawing.
2. This drawing to be read & printed in colour.
3. This drawing is for illustrative purposes only.

KEY:

	SITE BOUNDARY
	AREA TO BE STOPPED UP

A	Red line boundary revised.	RB	WS	07.12.20
Rev	Details	REVISION HISTORY		Date
Status:	<input checked="" type="checkbox"/> Preliminary	<input checked="" type="checkbox"/> For Approval	<input checked="" type="checkbox"/> For Construction	
	<input checked="" type="checkbox"/> For Information	<input checked="" type="checkbox"/> For Tender	<input checked="" type="checkbox"/> As Built	

Client: **The Collective**

Project: **Chatfield Road Stopping Up**

Drawing Title: **Stopping Up Plan**

Scale: **AS SHOWN** Size: **A3**

Drawn by: **COS** Checked by: **RB** Date: **21.10.2020**

CANEPARO ASSOCIATES
Transport Planning & Highway Design
21 Little Portland Street • London • W1W 8BT • Tel. 020 3617 8200

Scheme Ref: **CA4433** Drawing No: **001** Sheet: **1 of 1** Rev: **A**