

PLANNING

SMC ALSOP Partgate Studio
41 Partgate Road
London SW11 4NP
0044 (0)20 7978 7878

Structural Engineer AKT	Services Engineer Max Fordham	Project Manager
Project QS Gleeds	CDM Co-ordinator NHBC	Main Contractor

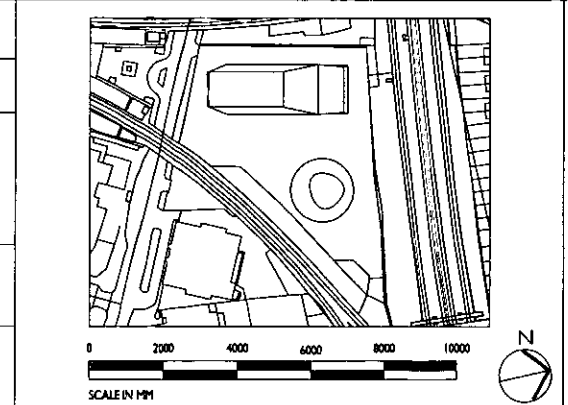

general notes

- do not scale drawings
- all dimensions are in millimetres unless otherwise stated
- all dimensions shall be verified on site before proceeding with the work
- this drawing to be read in conjunction with all relevant structural, mechanical and electrical information
- this drawing to be read in conjunction with all SMC ALSOP's drawings

SMC ALSOP's role on this project is that of Designer as defined in Regulation 2 of the Construction (Design and Management) Regulations 2007 (CDM). The design has been prepared with regard for the need under CDM Regulations 11, 18 and associated Regulations to eliminate hazards which may give rise to risks and reduce risks from any remaining hazards. CDM affects the Contractor's normal health and safety obligations when undertaking constructional operations. You are reminded of your duties under CDM and particularly to consider matters detailed in the pre-construction information. Professional advice should be sought if you are in any way unclear as to your obligations under CDM.

REVISIONS

Rev	Description	By	Date	Chk	Auth
A	Planning Submission	AB	01.06.08	VL	MT

RETAIL / RESTAURANT
OFFICE
RESIDENTIAL
AMENITY SPACE
PLANT / PARKING

APPROXIMATE POSITION OF BASE OF COLUMN SUPPORTING OVERHEAD STRUCTURE

Client
ORACLE RESIDENTIAL

Project
NO.1 PUTNEY PLACE

Title
LEVEL 00 PLAN (GROUND)

Original Scale 1:200	Drawn SK Date 26.10.07	Checked VL Date 26.10.07	Authorised MT Date 26.10.07	Sheet A 3
Drawing Number 1297_86_100				Rev A

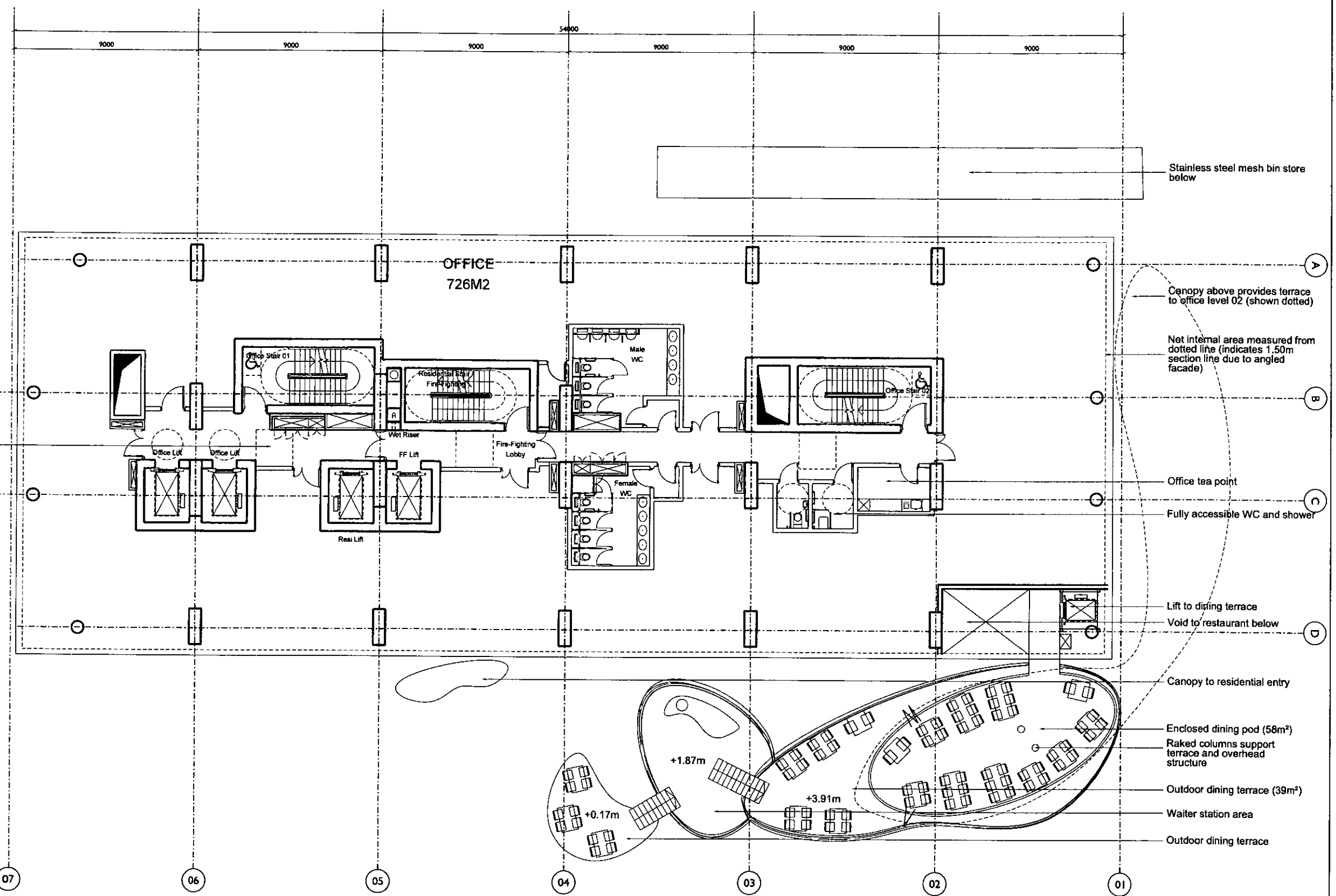

Wheelchair turning circles and passing places in corridors shown dotted

Stainless steel mesh bin store below

Canopy above provides terrace to office level 02 (shown dotted)

Net internal area measured from dotted line (indicates 1.50m section line due to angled facade)

Office tea point

Fully accessible WC and shower

Lift to dining terrace

Void to restaurant below

Canopy to residential entry

Enclosed dining pod (58m²)

Raked columns support terrace and overhead structure

Outdoor dining terrace (39m²)

Waiter station area

Outdoor dining terrace

PLANNING



Partgate Studio
41 Partgate Road
London SW11 4NP
0044 (0)20 7978 7878

Structural Engineer: AKT
Services Engineer: Max Forthorn
Project Manager:

Project QS: Gleeds
CDM Co-ordinator: NHBC
Main Contractor:

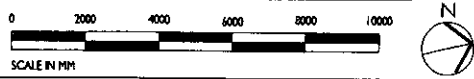
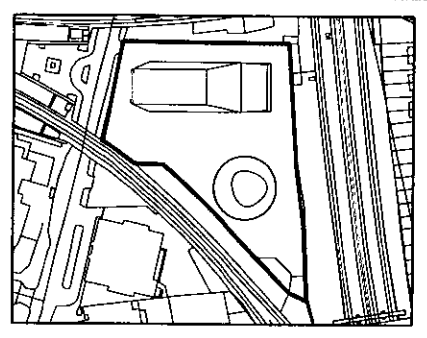

- general notes
- do not scale drawings
 - all dimensions are in millimetres unless otherwise stated
 - all dimensions shall be verified on site before proceeding with the work
 - this drawing to be read in conjunction with all relevant structural, mechanical and electrical information
 - this drawing to be read in conjunction with all SMC ALSOP's drawings

SMC ALSOP's role on this project is that of Designer as defined in Regulation 2 of the Construction (Design and Management) Regulations 2007 (CDM). The design has been prepared with regard for the need under CDM Regulations 11, 18 and associated Regulations to eliminate hazards which may give rise to risks and reduce risks from any remaining hazards. CDM affects the Contractor's normal health and safety obligations when undertaking constructional operations. You are reminded of your duties under CDM and particularly to consider matters detailed in the pre-construction information. Professional advice should be sought if you are in any way unclear as to your obligations under CDM.

REVISIONS

Rev	Description	By	Date	Chkd	Auth
A	Planning Submission	AB	01.06.09	VL	MT

Client: **ORACLE RESIDENTIAL**

Project: **NO.1 PUTNEY PLACE**

Title: **LEVEL 01 PLAN**

Original Scale	Drawn SK	Checked VL	Authorised MT	Sheet A3
1:200	Date: 26.10.07	Date: 26.10.07	Date: 26.10.07	Rev A

Drawing Number: **1297_86_101**

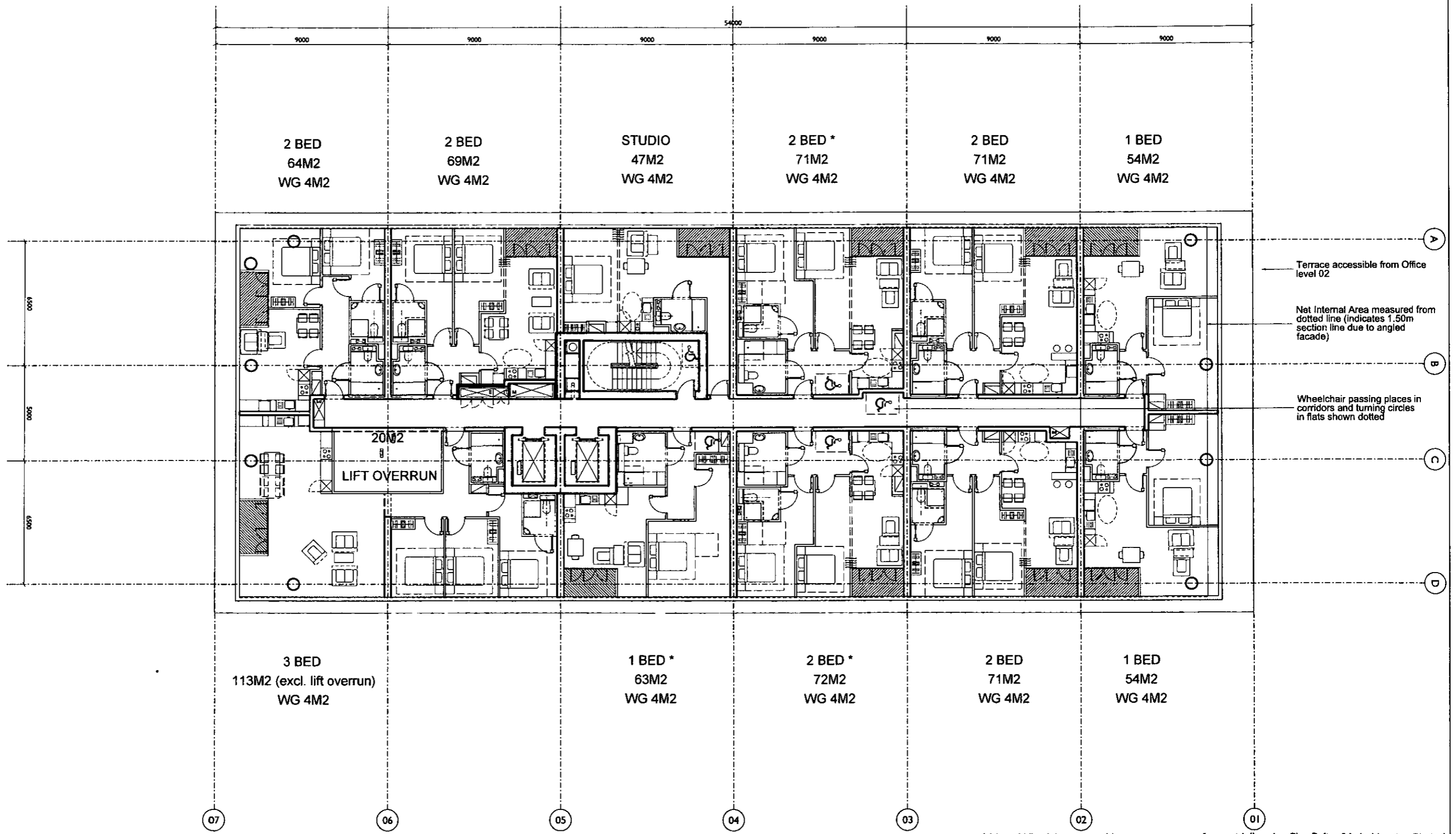

— Terrace accessible from Office level 02

Net Internal Area measured from dotted line (indicates 1.50m section line due to angled facade)

Wheelchair passing places in corridors and turning circles in flats shown dotted

* Note: Wheelchair accessible apartment to conform with 'London Plan Policy 3A.4 - Housing Choice'

PLANNING

SMC ALSOP Parkgate Studio
41 Parkgate Road
London SW11 4NP
0044 (0)20 7778 7878

Structural Engineer AKT	Services Engineer Max Fortham	Project Manager
Project QS Gleeds	CDM Co-ordinator NHBC	Main Contractor

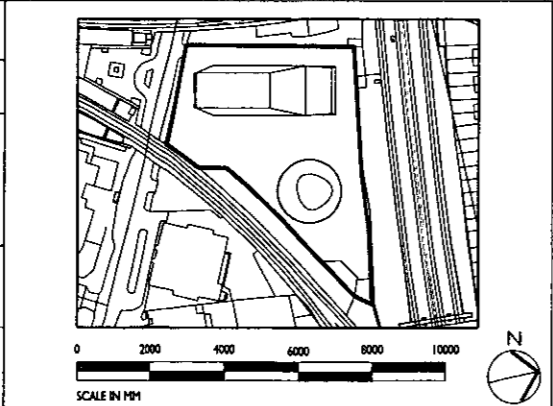

general notes

- do not scale drawings
- all dimensions are in millimetres unless otherwise stated
- all dimensions shall be verified on site before proceeding with the work
- this drawing to be read in conjunction with all relevant structural, mechanical and electrical information
- this drawing to be read in conjunction with all SMC ALSOP's drawings

SMC ALSOP's role on this project is that of Designer as defined in Regulation 2 of the Construction (Design and Management) Regulations 2007 (CDM). The design has been prepared with regard for the need under CDM Regulations 11, 18 and associated Regulations to eliminate hazards which may give rise to risks and reduce risks from any remaining hazards. CDM affects the Contractor's normal health and safety obligations when undertaking constructional operations. You are reminded of your duties under CDM and particularly to consider matters detailed in the pre-construction information. Professional advice should be sought if you are in any way unclear as to your obligations under CDM.

REVISIONS

Rev	Description	By	Date	Chk	Auth
A	Planning Submission	SK	01.06.03	VL	MT

Client
ORACLE RESIDENTIAL

Project
NO.1 PUTNEY PLACE

Title
LEVEL 04 PLAN

Original Scale 1:200	Drawn SK	Checked VL	Authorised MT	Sheet A 3
	Date 26.10.07	Date 26.10.07	Date 26.10.07	Rev A

Drawing Number
1297_86_104

© 2008 SMC ALSOP